

INSTRUCTIONS
FOR USE

A-dec® 343pro

CART DELIVERY SYSTEM

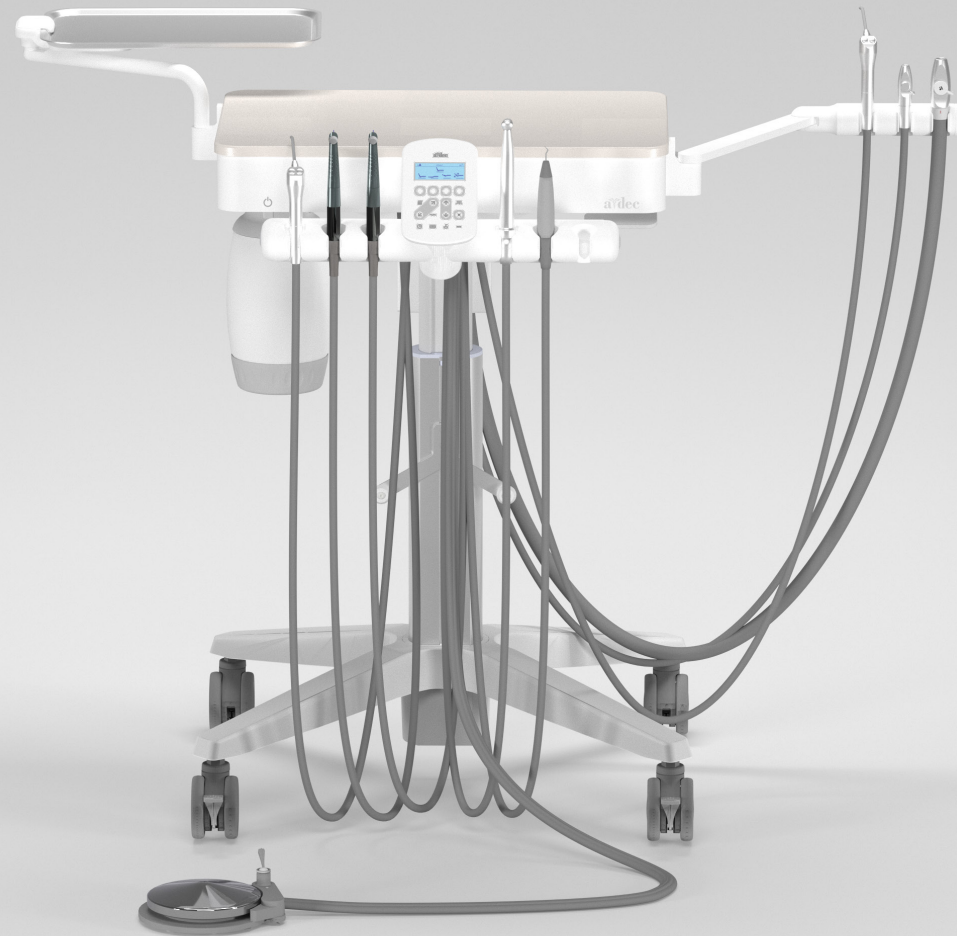

a dec®

Copyright

© 2026 A-dec, Inc. All rights reserved.

A-dec, Inc. makes no warranty of any kind with regard to this material, including, but not limited to, the implied warranties of merchantability and fitness for a particular purpose. A-dec, Inc. shall not be held liable for any errors contained herein or any consequential or other damages concerning the furnishing, performance or use of this material. The information in this document is subject to change without notice. If you find any problems in the documentation, please report them to us in writing. A-dec, Inc. does not warrant that this document is error-free.

No part of this document may be copied, reproduced, altered, or transmitted in any form or by any means, electronic or mechanical, including photocopying, recording, or by any information storage and retrieval system, without prior written permission from A-dec, Inc.

Intellectual Property Rights

None of the trademarks, trade names, or proprietary symbols and icons in this document may be reproduced, copied, or manipulated in any manner without the express, written approval of the trademark owner.

A-dec, the A-dec design logo and the trademarks listed at www.a-dec.com/legal/trademarks are trademarks of A-dec, Inc. and are registered in the United States and other countries. Certain touchpad symbols and icons are proprietary to A-dec, Inc. Any use of these symbols or icons, in whole or in part, without the express written consent of A-dec, Inc., is strictly prohibited.

In the United States, Kerr and Dispos-a-Trap are trademarks or registered trademarks of the Kerr Corporation. These may also be trademarks or registered trademarks in other countries.

Regulatory Information and Warranty

For required regulatory information and the A-dec warranty, see the *Regulatory Information, Specifications, and Warranty* document (p/n 86.0221.00) available in the Resource Center at www.a-dec.com.



For quick access to this document online, scan, tap, or click this QR code, which points to: a-dec.com/regulatory-guide.

Product Service

Product service is available through your local authorized A-dec dealer. For service information, or to locate an authorized dealer, contact A-dec at 1.800.547.1883 in the USA and Canada or +1.503.538.7478 worldwide, or visit www.a-dec.com.

Product Models and Versions Covered in This Document*

| Models | Versions | Description |
|--------|----------|-----------------|
| 343pro | n/a | Delivery System |

* Equipment shown in this document may include optional features or accessories. Some products, versions, and options in this document may not be available in certain regions.

Content Map

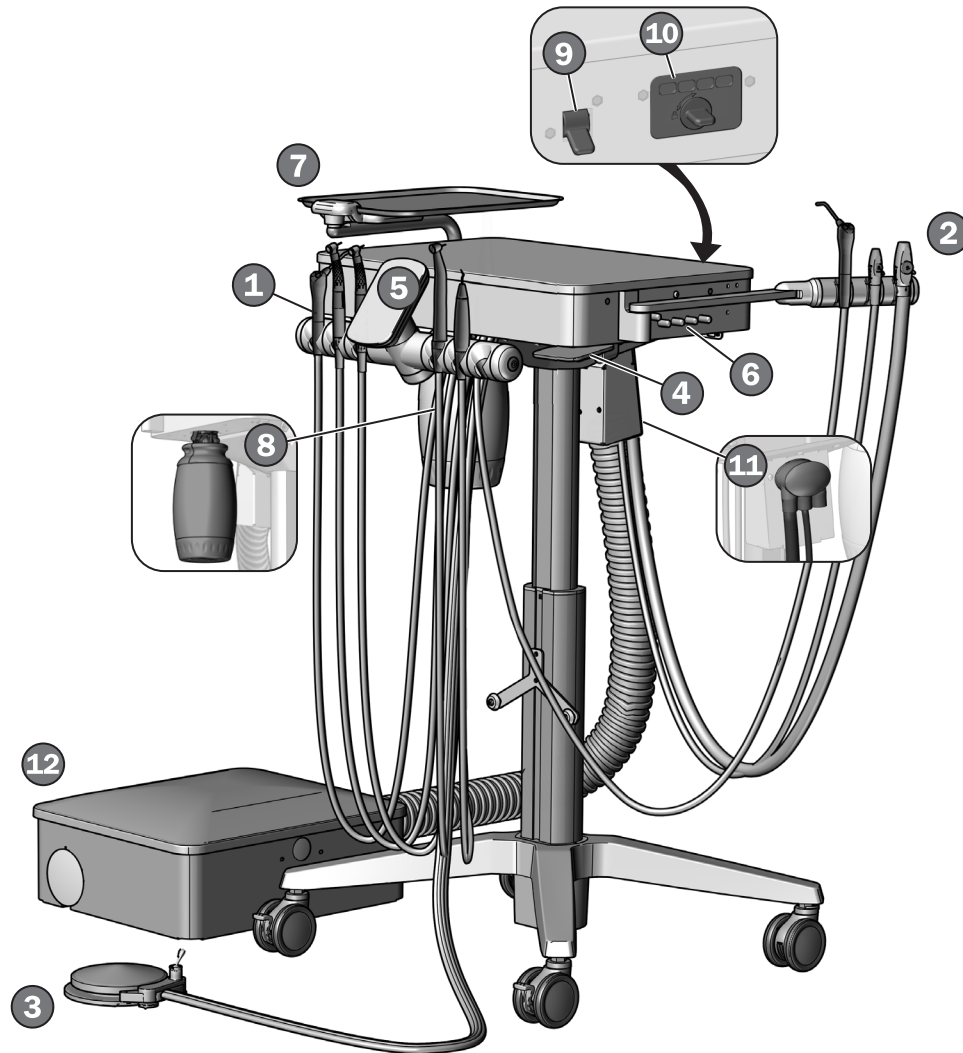

Features/Topics

| | | |
|----|--|-------|
| 1 | Master Toggle (<i>hidden</i>) | 2 |
| 2 | HVE/Saliva Ejector | 3, 15 |
| 3 | Foot Control | 5 |
| 4 | Height Adjustment | 2 |
| 5 | Touch Controls..... | 4 |
| 6 | Handpiece Coolant/ Handpiece Drive Air | 6, 7 |
| 7 | Tray Holder Mount..... | 9 |
| 8 | Self-Contained Water Bottle/ Waterline Maintenance..... | 11 |
| 9 | Handpiece Tubing Flush | 12 |
| 10 | Oil Collector | 13 |
| 11 | Solids Collector..... | 14 |
| 12 | Utilities | 19 |
| | Specifications | 20 |

Operate/Adjust

Turn On/Turn Off the Air, Water, and Power

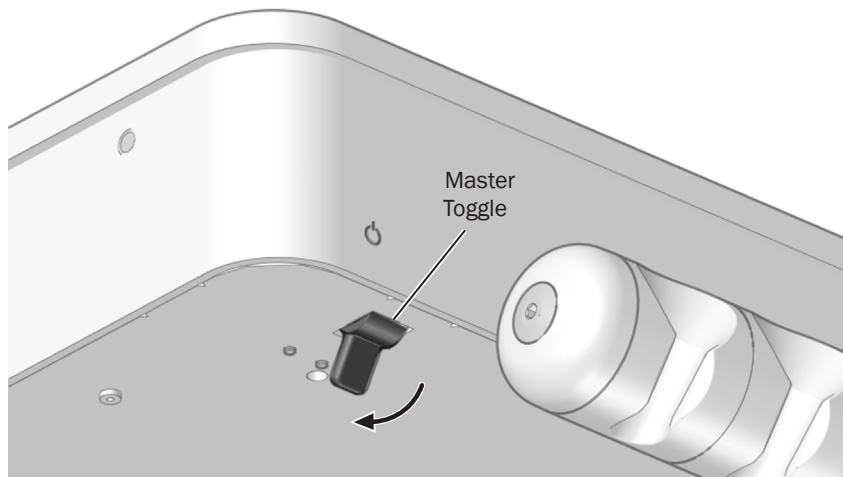

NOTE A-dec recommends that you perform a shock treatment on the dental unit waterlines before you use the system for the first time. For more information, see “Waterline Maintenance” on page 11.

Master Toggle

Use the master toggle to turn on the system air, water, and power. The toggle is located on the left side of the cart, under the delivery system front cover.

When to Turn Off the Power

To save energy and reduce the chance of air leaks, turn off the system power at the end of the work day and before longer periods of non-use.

Raise and Lower the System

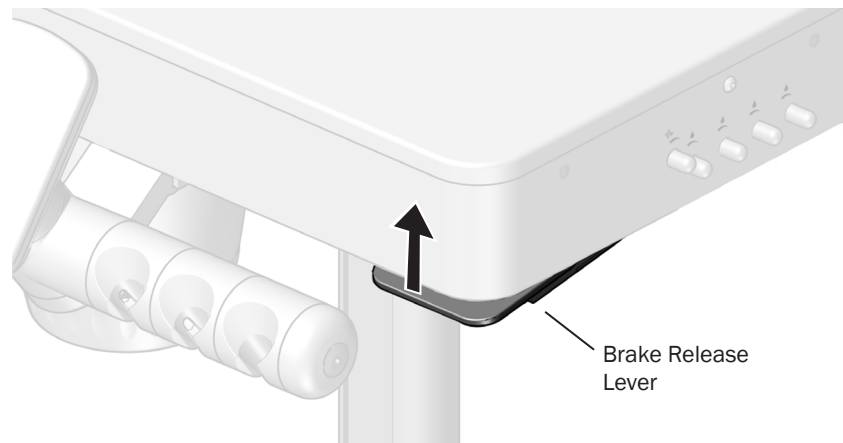

CAUTION Use care when raising and lowering the cart system. Depending on the configuration and load, the control head may rise or lower more quickly than expected.

To raise and lower the system:

1. Grasp the left and right side of the control head with your right hand over the brake release lever.
2. Pull up on the lever to disengage the brake and reposition the control head.
3. Release the lever to re-engage the brake.

Position the Instrument Holders

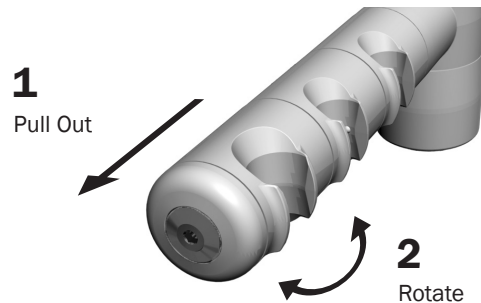

CAUTION Twisting the holder without pulling it away from the adjacent one will damage the mechanism.

You can adjust the instrument holders independently or as a set (on the doctor's side and the assistant's side).

1. Pull the holder, or holders, away from the touchpad/handle.
2. Rotate to the desired position and release.

Assistant's Instrumentation

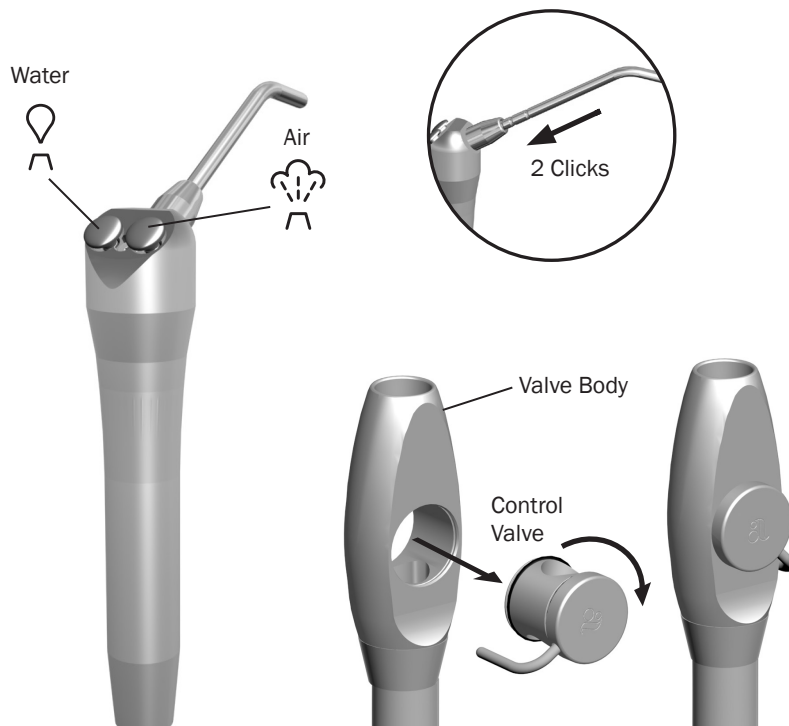

Operate the Autoclavable Syringe

To install the A-dec syringe tip, push the tip in until you feel two clicks. Press both buttons simultaneously for the air/water spray.



IMPORTANT For more details on syringe usage and maintenance, see your A-dec syringe Instructions for Use.

HVE/Saliva Ejector Left/Right Conversion

To convert the high-volume evacuator (HVE) and saliva ejector for left-handed operation, push the control valve out of the valve body, rotate the control valve 180°, and push it back into place.



NOTE Be sure to reinstall the valve on the same side of the valve body. Otherwise, the HVE or saliva ejector will not operate properly.

CP5i/CP5 Control Pads*



For control pad use, see the *A-dec DS7/CP5i/CP5 Touch Controls Instructions for Use* (p/n 86.0857.00) at a-dec.com/touchscreen-manual.



For configuring connectivity features, see the *A-dec+™ Software Platform Instructions for Use* (p/n 86.1030.00) at a-dec.com/connectivity-manual.



*Note. Touch control symbols and icons are proprietary to A-dec, Inc.

Operate the Foot Control

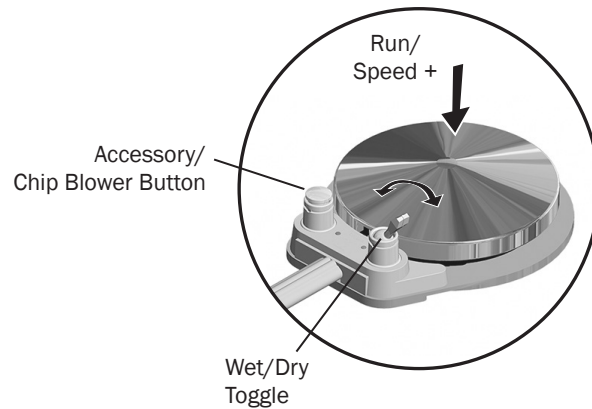

To activate a handpiece, lift it from the holder. Use the foot control to perform the desired handpiece operation.

| Control | Operation | Procedure |
|--------------------------|--|---|
| Disc Foot Control | Run a handpiece. | Press on the disc. Push down to increase speed. |
| | Run a handpiece with or without water coolant. | CP5i control pad: Use the control pad to turn the coolant on or off, or flip the wet/dry toggle (which works as a three-way switch in conjunction with the control pad). Then press on the disc. CP5 control pad or no touch control: Flip the wet/dry toggle. Then press on the disc. |
| | Run the accessory/chip blower. | Press the accessory/chip blower button.* |
| | Operate the intraoral camera. | Press on the disc to capture an image.* |

* Contact your authorized A-dec dealer for questions about the operation or configuration of your integrated A-dec sanctioned clinical devices.

Adjust the Handpiece Coolant Spray

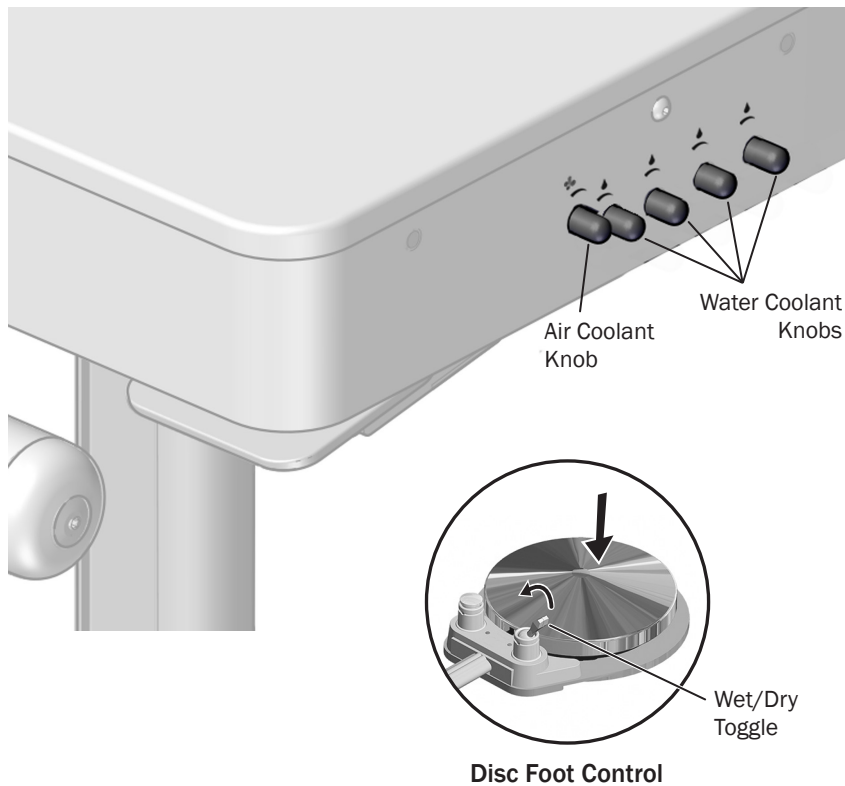

CAUTION When performing this procedure, do not attempt to completely shut off the water or air flow. The adjustment knobs are not designed to completely shut off flow and can damage the control block if you apply too much force.

The air coolant knob on your delivery system simultaneously adjusts air flow to all air-driven handpiece positions. Each water coolant knob adjusts water flow to a single position. Use the following process to adjust for the desired handpiece coolant atomization:

1. Insert a bur into each handpiece you are adjusting.
2. Turn the air coolant adjustment knob clockwise until it stops.
3. Withdraw a handpiece, flip the wet/dry toggle on the foot control to wet, then press the disc all the way down.
4. Locate the water coolant adjustment knob for the handpiece position you are adjusting and turn it clockwise until coolant flow stops.
5. Slowly turn the water coolant adjustment knob counterclockwise until water droplets are expelled from every water port on the handpiece head. Return the handpiece to the holder.
6. Repeat steps 3 through 5 for each handpiece.
7. To set the coolant spray, withdraw a handpiece and turn the air coolant adjustment knob counterclockwise until you achieve the desired atomization at the cutting surface of the bur.



CAUTION Do not continue turning the air coolant adjustment knob counterclockwise after the air coolant stops increasing. The stem may come out of the control block.

8. If you require more water coolant, increase the water output in step 5 as needed.

Adjust the Handpiece Drive Air Pressure

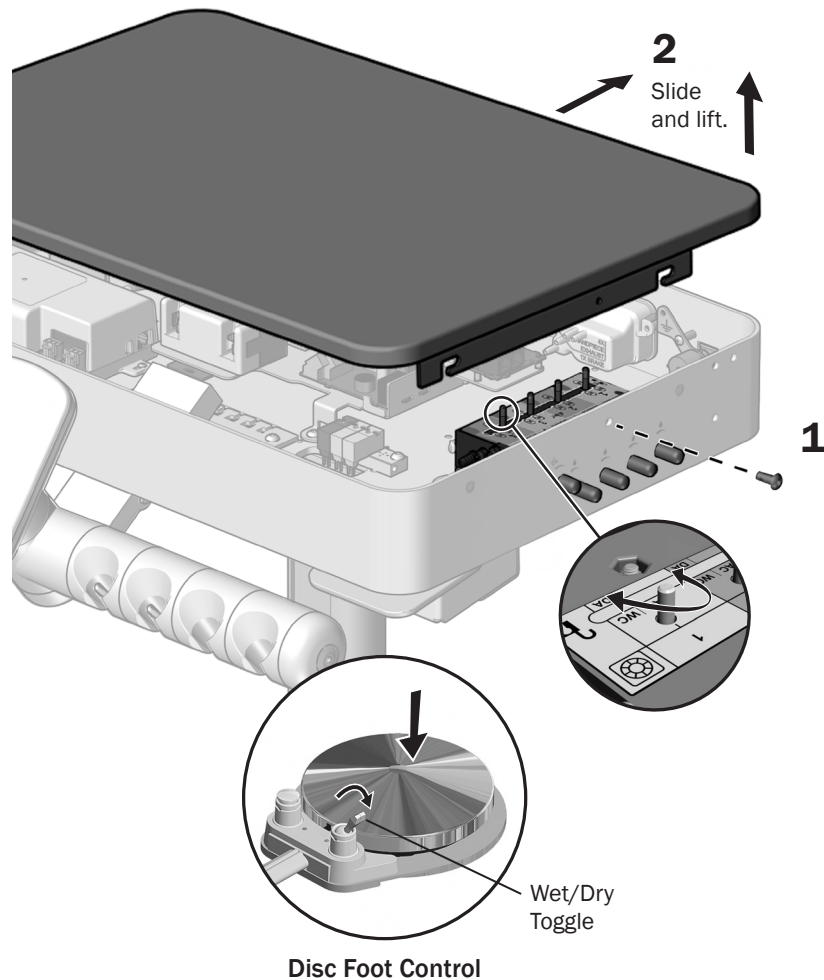

WARNING Shock hazard. When you remove or replace the covers, take care not to damage any wiring or tubing. Verify that the covers are secure after you replace them.



CAUTION Exceeding the manufacturer's recommended drive air pressure increases the risk of damage and may significantly decrease the life of your handpiece components. For the proper drive air pressure, see the handpiece manufacturer's Instructions for Use.

For the most accurate drive air measurement, use a handpiece pressure gauge attached to the handpiece tubing.

To adjust the drive air pressure for each handpiece:

1. Use a 1/8" hex key to remove the two side cover screws (one on the right side and one on the left side of the control head).
2. Slide the cover back about 1/4" (6 mm) and lift to remove it.
3. Lift the handpiece from the holder and install a handpiece pressure gauge.
4. Flip the wet/dry toggle on the foot control to dry, then press the disc all the way down.
5. With the handpiece running, check the handpiece pressure gauge.
6. Locate the drive air pressure controls inside and adjust the handpiece drive air pressure to meet the manufacturer's specifications. Turn the control stem clockwise to decrease flow and counterclockwise to increase flow.
7. When you reinstall the cover, slide it forward into place, install the right-side screw first, then install the left-side screw. Be careful not to overtighten the screws.

Adjust the Handpiece Drive Air Pressure *(continued)*

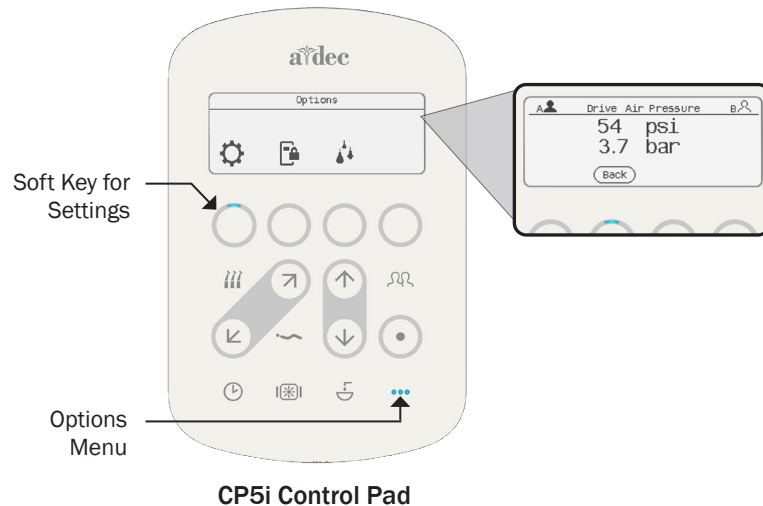
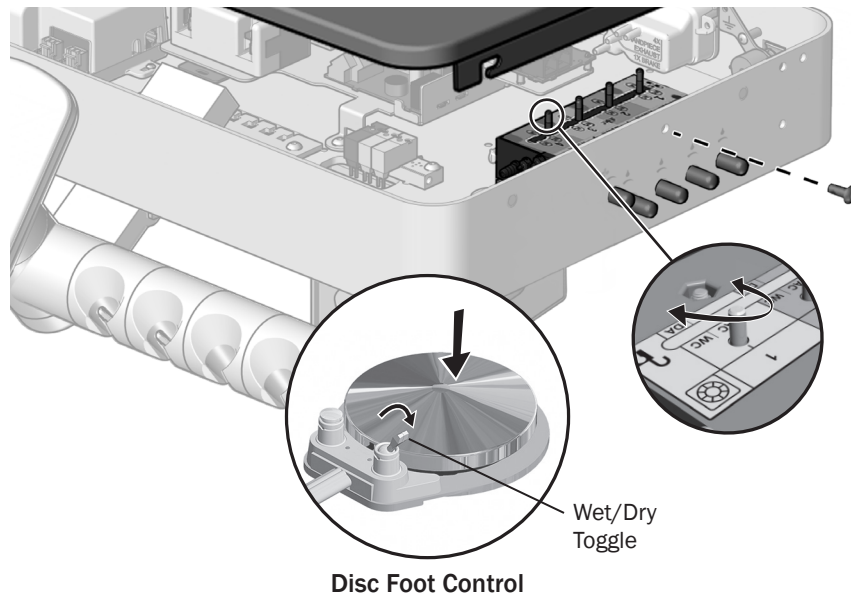

On systems with the CP5/CP5i control pad, you can use the interface to read drive air pressure in lieu of a handpiece pressure gauge.



NOTE Drive air pressure may be lower at the handpiece than what is shown on the touch control. For the most accurate measurement, use a handpiece pressure gauge.

To read and adjust the drive air pressure while using a CP5/CP5i control pad:

1. Follow steps 1-2 on page 7 to remove the cover.
2. On the control pad, press ●●● to access the **Options** menu.
3. Press the soft key under the ⚙ icon.
4. Select **Diagnostics**.
5. Scroll down and select **Drive Air Pressure**.
6. Withdraw a handpiece.
7. On the disc foot control, flip the wet/dry toggle to dry, and press the disc all the way down.
8. Check the control pad screen to view the pressure reading.
9. Adjust the handpiece drive air pressure to meet the manufacturer's specifications. Turn the control stem clockwise to decrease flow and counterclockwise to increase flow.
10. Follow step 7 on page 7 to reinstall the cover.

Adjust the Tray Holder Mount Rotation

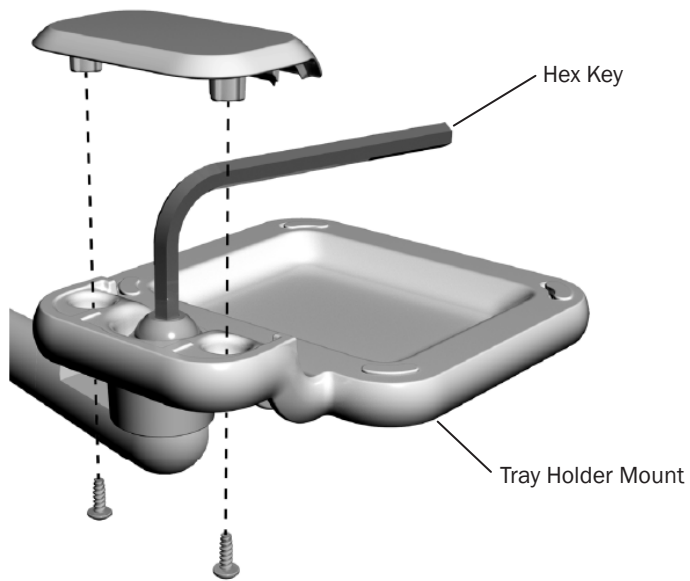

If the tray holder mount rotation is too tight or too loose, use a 7/32" hex key to adjust the tension:

1. Use a Phillips head screwdriver to remove the screws holding the cap. Remove the cap.
2. Insert the hex key into the tension bolt and turn clockwise to increase the tension.
3. Reinstall the cap.

Clean/Maintain

Protect with Barriers

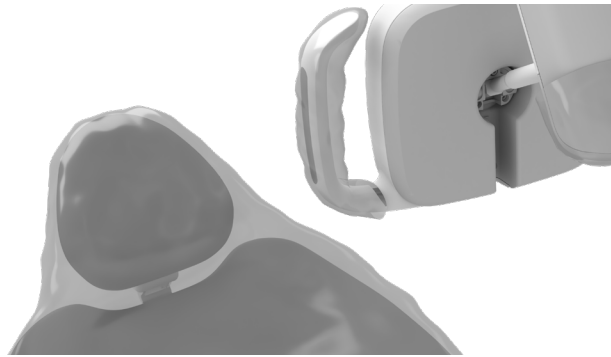

NOTE For proper use and disposal of barriers, see the barrier manufacturer's Instructions for Use.



IMPORTANT For recommendations on cleaning and chemical disinfection of touch and transfer surfaces (where barrier protection is not applicable or when barriers are compromised), please see the *A-dec Equipment Asepsis Guide* (p/n 85.0696.00).

A-dec recommends barrier protection for all applicable touch and transfer surfaces. Touch surfaces are areas that come into contact with hands and become potential cross-contamination points during dental procedures. Transfer surfaces are areas that come into contact with instruments and other inanimate objects.

In the USA, barriers must be produced under the Current Good Manufacturing Practice (CGMP) as specified by the U.S. Food and Drug Administration (USFDA). For regions outside the USA, refer to the medical device regulations specific to your location.

Waterline Maintenance



A-dec recommends that you use ICX Renew® dental unit waterline shock treatment* before you use the system for the first time.

For on-going waterline maintenance, A-dec recommends a three-part protocol:

- Continuous use of A-dec ICX® waterline treatment tablets
- Regularly monitor the water quality in your dental equipment
- Shock treatment whenever the test results exceed your established water quality action level



IMPORTANT For complete details on how to maintain good water quality, see the appropriate Instructions for Use provided with your A-dec waterline maintenance products.



For quick access to these documents online, scan, tap, or click this QR code, which points to: a-dec.com/waterline-manuals.

* *Note.* ICX Renew may be sold under different names in different regions.

Flush the Handpiece Tubing

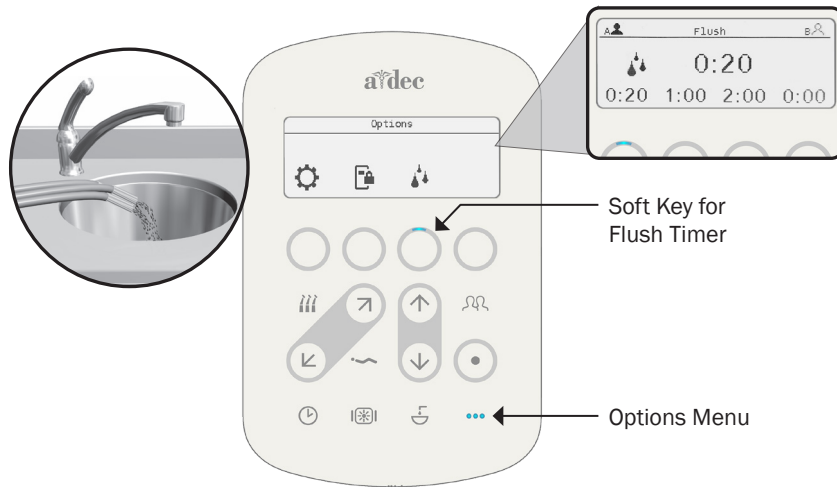

NOTE Flush all handpiece tubing (air and waterlines) in accordance with the regulations in your area. If no regulations exist, flush the tubing for a minimum of 20–30 seconds at the beginning of the day and after each patient.

Systems with CP5i Control Pad

Use the flush feature on the control pad to move a high volume of water through the handpiece tubing. To flush the tubing after each patient:

1. Disconnect the handpieces and hold the tubing over a sink, cuspidor bowl, or basin.
2. On the control pad, press ●●● to access the **Options** menu.
3. Press the soft key under  for the flush timer.
4. Select the soft key for desired flush time. (*Note. For more details on flush timer options, see the A-dec DS7/CP5i/CP5 Touch Controls Instructions for Use referenced on page 4.*)

Systems with CP5 Control Pad or No Control Pad

Use the flush toggle on the back of the control head to move a high volume of water through the handpiece tubing. To flush the tubing after each patient:

1. Disconnect the handpieces and hold the tubing over a sink, cuspidor bowl, or basin.
2. Flip the flush toggle up and hold for the appropriate amount of time.

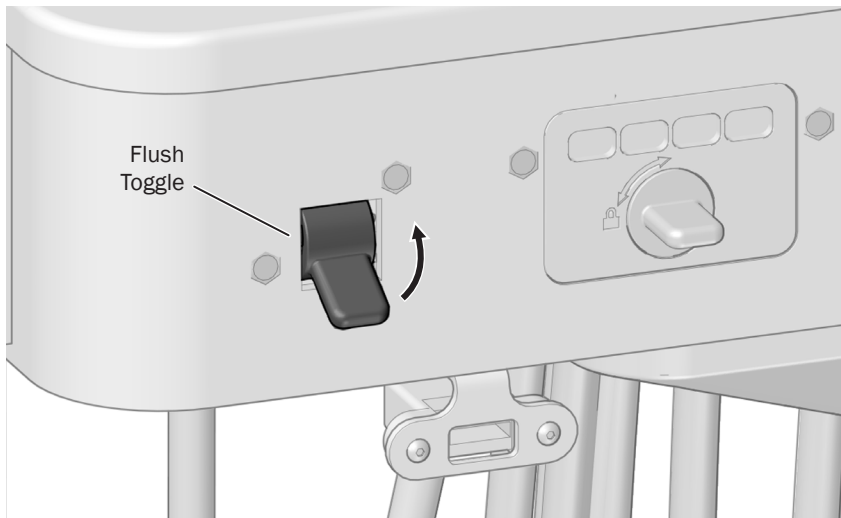

Maintain the Oil Collector

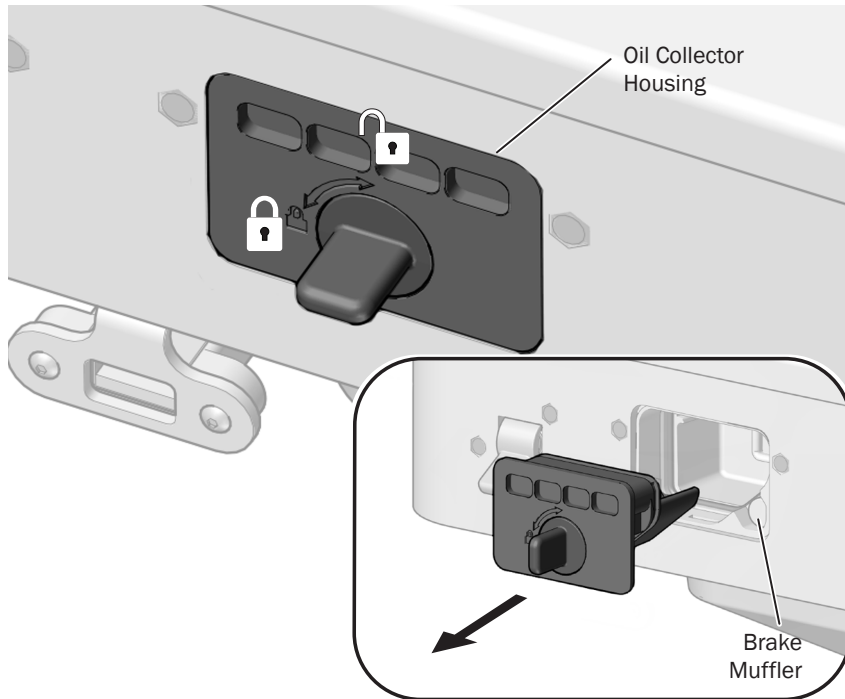

Service the oil collector on the delivery system once a week for normal use and more often for heavier use. To service:

1. Turn the oil collector housing key clockwise to unlock, then pull out the housing from the control head.
2. Remove and replace the old cotton gauze (use two 2" x 2" [51 mm x 51 mm] pads folded in half).



NOTE Do not replace the cotton roll in the right corner of the oil collector. This is a brake muffler that will rarely need replacement. For more information, see your local authorized A-dec dealer.

3. Reinsert the housing and turn the key counterclockwise to lock.

Maintain Solids Collector

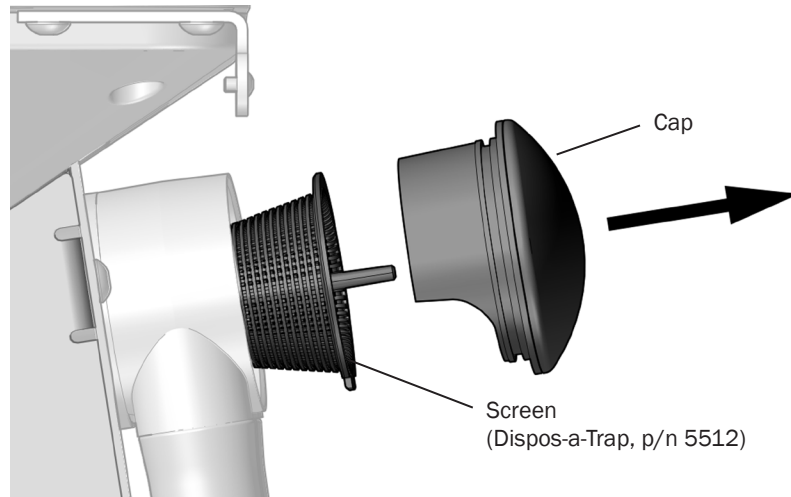

WARNING Infectious waste may be present. Follow asepsis protocol to prevent cross contamination.

The solids collector helps prevent solids from entering the central vacuum system. To ensure proper suction from the central vacuum and maintain proper treatment room asepsis, discard and replace the solids collector screen at least twice a week.



TIP To obtain replacement solids collector screens, contact your authorized A-dec dealer and reference the Kerr® Dispos-a-Trap™ (p/n 5512).

To replace the solids collector screen:

1. Turn off the vacuum or open the HVE control valve.
2. Remove the solids collector cap.



CAUTION Do not empty the screen into your cuspidor. Doing so could plug the drain.

3. Remove the solids collector screen and discard according to your local regulations.



NOTE When you replace the solids collector cap, ensure that the keyed cutout faces down, or it will cut off the vacuum flow.

4. Insert a new screen in the solids collector and replace the cap.

A-dec HVE/Saliva Ejector Valve Body Assembly Asepsis

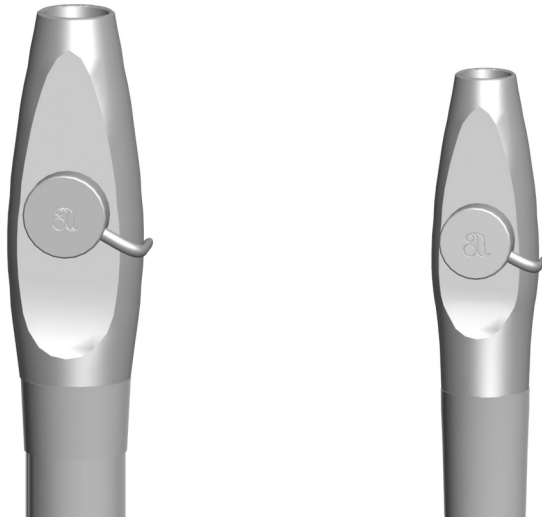

NOTE Vacuum lines should be flushed at the end of each day or more frequently according to your clinic's protocols.

If you use barriers to protect the main body of the HVE and saliva ejector, replace the barriers after each patient. Clean and disinfect these instruments at the end of each day or after each patient if the barriers have been compromised. If you do not use barriers, or if you perform oral surgery, always clean and disinfect these instruments after each patient.

Cleaning and Disinfection



CAUTION Clean the valve body assembly as soon as possible after treating each patient. Do not allow blood and debris to dry on instruments. If you cannot clean it immediately, keep the valve body assembly moist.



NOTE Use an intermediate-level EPA-registered hospital-grade disinfectant containing a tuberculocidal claim with one of the following compositions: high-dilution water-based phenolic formulation or quaternary ammonium compound with less than 25% isopropanol.



NOTE If using a spray solution, spray on a soft, low-lint wipe to apply solution to the valve body assembly.

To clean and disinfect the HVE and saliva ejector valve body assembly without disconnecting from the vacuum system:

1. Remove the vacuum tip from the HVE or saliva ejector valve body assembly. Discard disposable vacuum tips.

A-dec HVE/Saliva Ejector Valve Body Assembly Asepsis *(continued)*

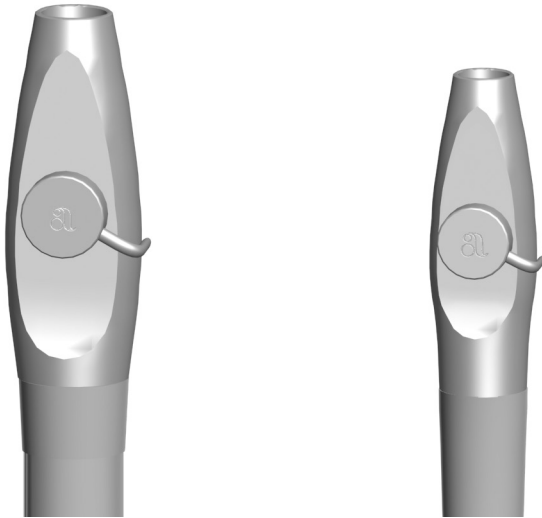

2. Clean the valve body assembly to remove visible soil using a disinfectant wipe or spray solution. Keep the valve body assembly wet according to the manufacturer's recommended contact time. Repeat, if necessary, until the valve body assembly is visibly clean.
3. Disinfect the valve body assembly using a new disinfectant wipe or spray solution. Keep the valve body assembly wet according to the manufacturer's recommended contact time.
4. Allow the valve body assembly to air dry.
5. Operate the HVE and the saliva ejector valves several times to verify that they rotate smoothly.

Routine Maintenance and Sterilization



CAUTION Clean the valve body assembly as soon as possible after treating each patient. Do not allow blood and debris to dry on instruments. If you cannot clean it immediately, keep the valve body assembly moist.



NOTE A-dec valve body assemblies are heat tolerant for sterilization. Users may sterilize at their discretion.

To routinely maintain and sterilize the HVE and saliva ejector when disconnected from the vacuum system (frequency determined by the user):

1. Remove the valve body assembly from the vacuum line by pulling it away from the tubing at the tailpiece.
2. Disassemble the valve body by pushing the control valve out of the valve body.
3. Clean soiled valve body components using a soft, low-lint wipe.

A-dec HVE/Saliva Ejector Valve Body Assembly Asepsis *(continued)*

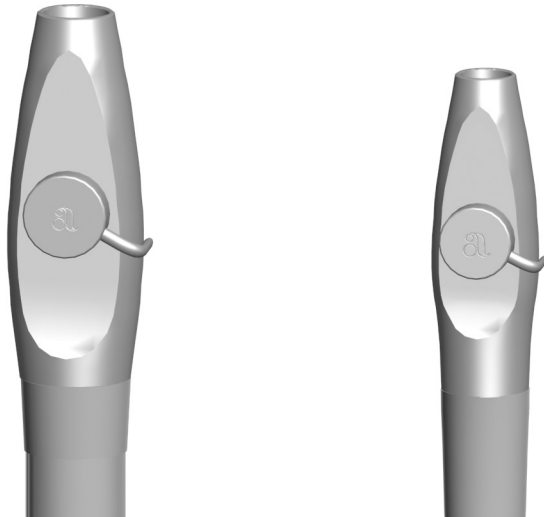

4. Prepare a warm (32-43°C [90-110°F]) detergent solution (neutral pH enzymatic detergent or alkaline non-enzymatic detergent), according to the manufacturer's recommended instructions.
5. Soak soiled valve body components in the prepared detergent solution for at least one minute or for as long as the manufacturer's recommended instructions indicate (whichever is longer).
6. Inspect O-rings. Remove, discard, and replace if there are visible signs of damage.
7. Use a soft, nylon-bristle brush, or equivalent, to scrub the:
 - Exposed surface of the valve body components, while submerged, for a minimum of 30 seconds or until all visible soil has been removed.
 - Interior lumen of the valve body at least three times (in and out), clearing any visible soil from brush bristles.
8. Rinse the cleaned valve body components under flowing, warm (32-43°C [90-110°F]) potable water for a minimum of 30 seconds.
9. Allow valve body components to air dry.
10. Sterilize the valve body components according to the following:
 - Dynamic air-removal sterilizers: 4 minutes at 132-135°C (270-275°F)
 - Gravity-displacement sterilizers: 30 minutes at 121-123°C (250-254°F)
11. Allow the load to dry for 30 minutes before removing it from the sterilizer. Ensure the valve body components are completely dry before proceeding.

A-dec HVE/Saliva Ejector Valve Body Assembly Asepsis *(continued)*

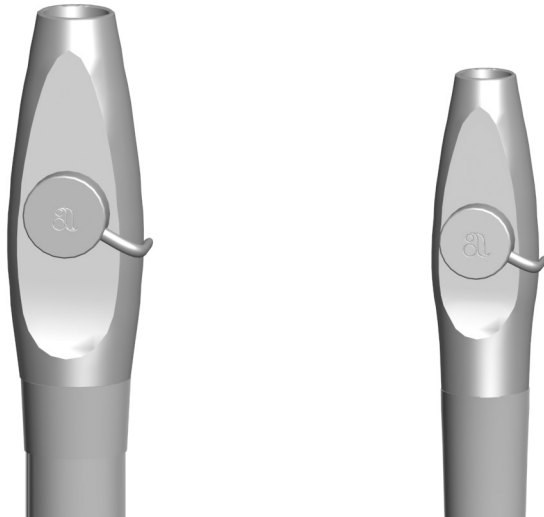

CAUTION Use only silicone lubricant when lubricating the black O-rings in A-dec instruments. Petroleum-based products will cause permanent damage to the O-rings.

12. Prior to use, lubricate O-rings with A-dec silicone lubricant, and reassemble the valve body assembly.
13. Reinstall the valve body assembly on the tubing tailpiece.
14. Operate the HVE and the saliva ejector control valves several times to verify that they rotate smoothly.

HVE/Saliva Ejector Tips



NOTE Select tips that are compatible with your HVE and saliva ejector openings. See “A-dec HVE/Saliva Ejector Tip Connections” on page 20 for specifications.

Disposable Tips



CAUTION Disposable HVE and saliva ejector tips are not sterilizable and should not be reused.



Replace disposable HVE and saliva ejector tips after each use.

Bulb for Fiber-Optic Tubing

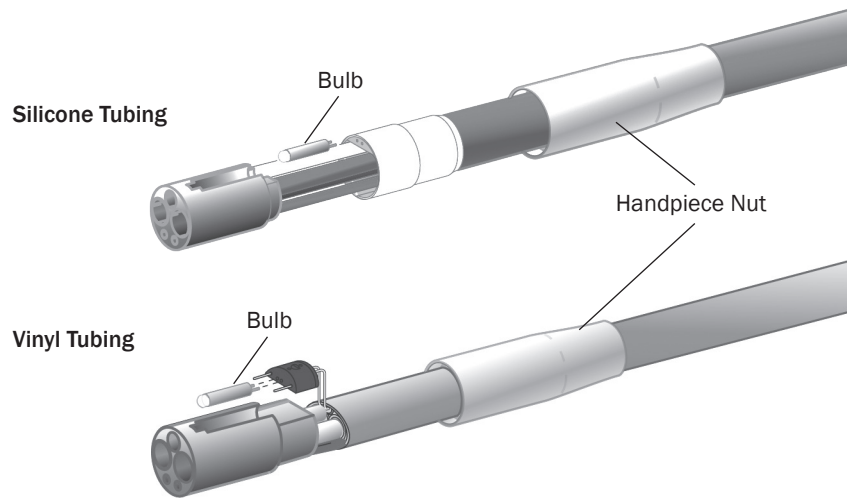

IMPORTANT To replace the bulb in your handpiece or quick-disconnect coupling, see your handpiece Instructions for Use.

To replace the bulb in your fiber-optic 5-hole silicone or vinyl tubing:

1. Disconnect the handpiece and quick-connector coupling from the tubing.
2. Pull back the metal handpiece nut.
3. Slide back the metal portion of the handpiece terminal (silicone tubing only).
4. Replace the bulb.
5. Reinsert the metal portion of the terminal into the plastic portion (silicone tubing only).
6. Carefully slide the handpiece nut back over terminal.

Access the Utilities

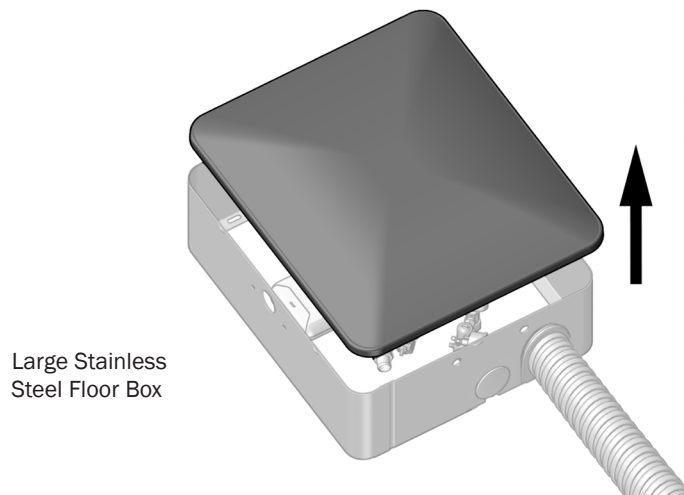

Warning Shock hazard. When you remove or replace the covers, take care not to damage any wiring or tubing. Verify that the covers are secure after you replace them.

The system utilities are typically located in the large stainless steel floor box. To access, lift up the floor box cover. For maintenance, contact your local authorized A-dec dealer.

Specifications



System Accessory Load

| | |
|--|---------------|
| Maximum accessory load capacity: <i>(in addition to integrated accessories)</i> | 25 lb (11 kg) |
| Maximum tray holder mount load capacity: | 4 lb (1.8 kg) |

A-dec HVE/Saliva Ejector Tip Connections

| | |
|----------------------------|---|
| Standard and Long Tip HVE: | 11 mm (0.433") diameter opening <i>(for standard HVE tips)</i> |
| Standard 6 mm SE: | 6 mm (0.236") diameter opening <i>(for standard HVE tips)</i> |

Solids Collector Screen/Filter

Maximum mesh opening size: 0.047" (1.194 mm) \cong 1200 μ m



IMPORTANT For electrical specifications, identification of symbols, and other regulatory requirements, see the *Regulatory Information, Specifications, and Warranty* document (p/n 86.0221.00) available in the Resource Center at www.a-dec.com.



For quick access to this document online, scan, tap, or click this QR code, which points to: a-dec.com/regulatory-guide.



NOTE Specifications are subject to change without notice. Requirements may vary depending on your location. For more information, contact your authorized A-dec dealer.



 **A-dec Headquarters**

2601 Crestview Drive
Newberg, Oregon 97132
United States
Tel: 1.800.547.1883 within USA/CAN
Tel: +1.503.538.7478 outside USA/CAN
www.a-dec.com

A-dec Australia

Unit 8, 5-9 Ricketty Street
Mascot, NSW 2020
Australia
Tel: 1.800.225.010 within AUS
Tel: +61.(0).2.8332.4000 outside AUS

A-dec United Kingdom

Austin House, 11 Liberty Way
Nuneaton, Warwickshire CV11 6RZ
England
Tel: 0800.ADEC.UK (2332.85) within UK
Tel: +44.(0).24.7635.0901 outside UK



86.1104.00 Rev B
Date of Issue 2026-01-29
Copyright 2026 A-dec, Inc.
All rights reserved.

IFUnewcov5